

DISTRICT DEPARTMENT OF THE ENVIRONMENT

CONTRACT DRAWINGS FOR AMIDON PARK SOIL DE-COMPACTION CONCEPT PLANS

VICINITY MAP

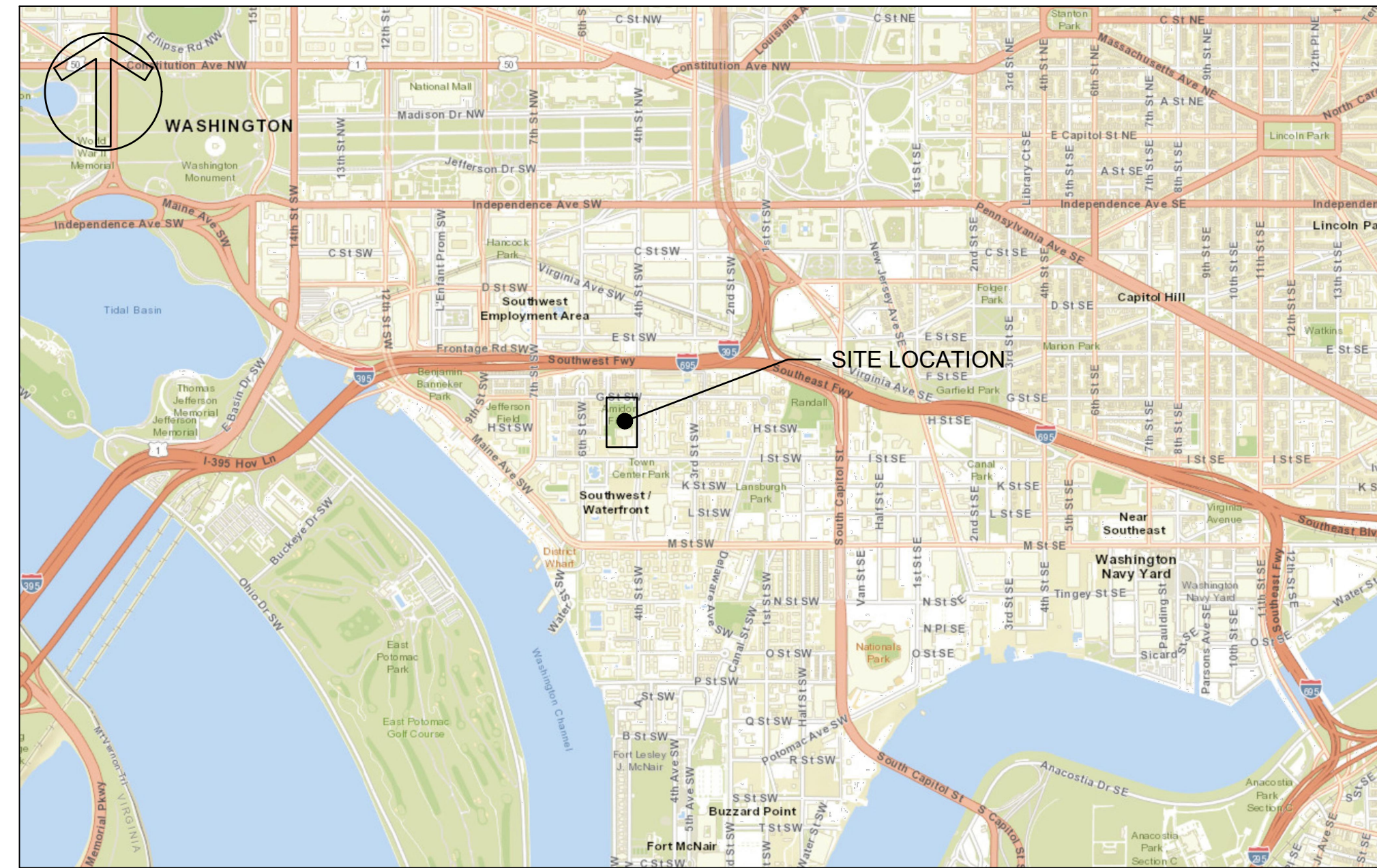

SCALE: 1" = 2,000'

Sheet List Table		
Drawing No.	Sheet Number	Sheet Title
GN01	1	TITLE SHEET
SP01	2	PROPOSED SUBSOILING LIMITS

CLIENT

DEPARTMENT OF ENERGY & ENVIRONMENT
 CECILIA LANE
 ENVIRONMENTAL ENGINEER
 WATERSHED PROTECTION DIVISION
 DEPARTMENT OF ENERGY AND ENVIRONMENT
 GOVERNMENT OF THE DISTRICT OF COLUMBIA
 1200 FIRST STREET, NE 5TH FLOOR
 WASHINGTON, DC 20002
 DESK: (202) 535-1961
 WEB: DOEE.DC.GOV

DATE:	ISSUES / REVISIONS



Biohabitats
 The Stables Building 2081 Clipper Park Road
 Baltimore, MD 21211 / ph: 410.554.0156
 fx: 410.554.0168 / www.biohabitats.com
Restore the Earth & Inspire Ecological Stewardship

AMIDON PARK SOIL DE-COMPACTION

TITLE:	
TITLE SHEET	
PROJECT NO. : 18030.01	SCALE: AS SHOWN
SEAL:	BY: TB CHECK: BA
DWG. NO. : GN01 OF 1	
SHEET NO. : 1 OF 2	

LEGEND

EXISTING	PROPOSED
— — — — — MAJOR CONTOUR	— — — — — 425 — — — — — MAJOR CONTOUR
— — — — — MINOR CONTOUR	— — — — — 424 — — — — — MINOR CONTOUR
— — — — — PROPERTY LINE	— — — — — AIRSPADE
— SS — — — — — SANITARY SEWER	■ — — — — — LIMITS OF SUBSOIL DECOMPACTION
— SD — — — — — STORM DRAIN	
— X — — — — — FENCE	
△ — — — — — TRAVERSE POINT	
⊙ — — — — — TREE	
⊙ — — — — — STORMDRAIN MANHOLE	
⊙ — — — — — SEWER MANHOLE	

STATEMENT BY PROFESSIONAL ENGINEER REGISTERED IN THE DISTRICT OF COLUMBIA

This is to certify that the engineering features of all stormwater best management practices (BMPs), stormwater infrastructure, and land covers (collectively the "Facility") have been designed/examined by me and found to be in conformity with modern engineering principles applicable to the treatment and disposal of stormwater pollutants. I further certify that the Facility has been designed in accordance with the specification required under Chapter 5 of Title 21 of the District of Columbia Municipal Regulations. It is also stated that the undersigned has furnished the applicant with a set of instructions for the maintenance and operation of the site's Facility.

X, PE _____
 Name and Title (please type)
 2081 Clipper Park Rd
 Address
 Baltimore, MD 21211
 Date _____ Phone No: 410.554.0156

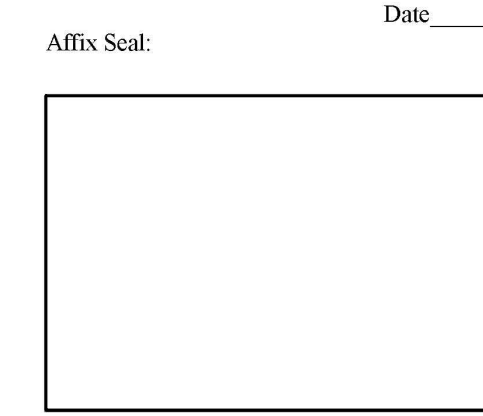

PROPERTY OWNER:
DC PARK & RECREATION

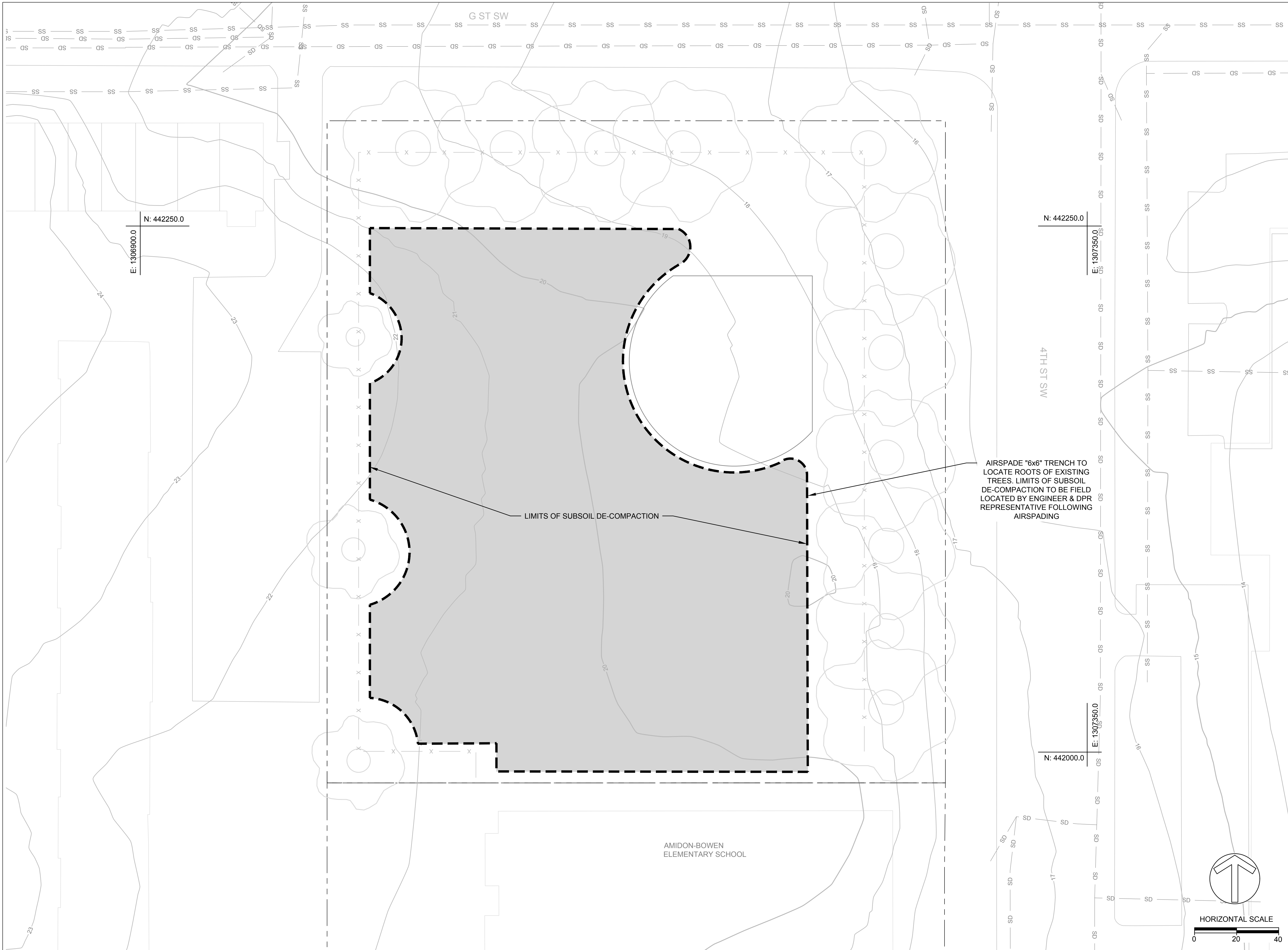

CLIENT

★ ★ ★

DEPARTMENT OF ENERGY & ENVIRONMENT

CECILIA LANE
 ENVIRONMENTAL ENGINEER
 WATERSHED PROTECTION DIVISION
 DEPARTMENT OF ENERGY AND ENVIRONMENT
 GOVERNMENT OF THE DISTRICT OF COLUMBIA
 1200 FIRST STREET, NE 5TH FLOOR
 WASHINGTON, DC 20002
 DESK: (202) 535-1961
 WEB: DOEE.DC.GOV

DATE:	ISSUES / REVISIONS

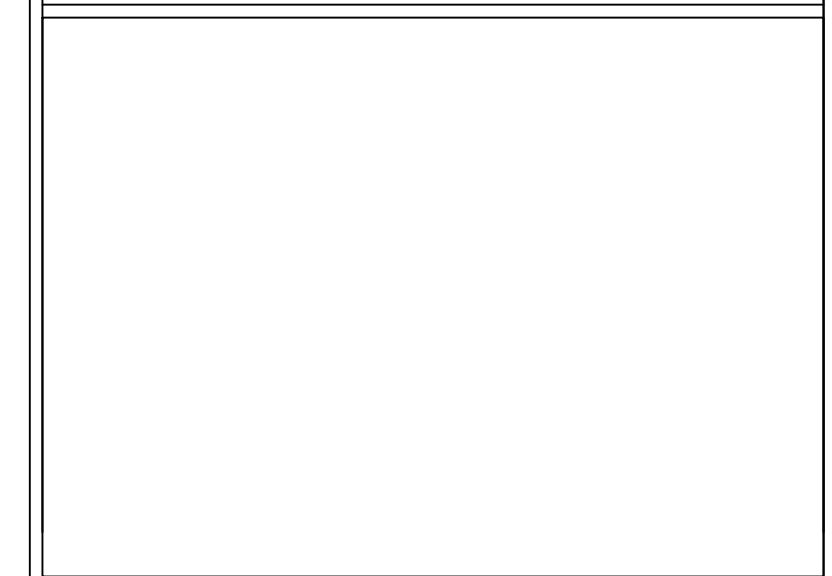

AMIDON PARK SOIL DE-COMPACTION

PROPOSED SUBSOILING LIMITS

PROJECT NO.:	18030.01	SCALE:	1" = 20'
SEAL:	BY: TB	CHECK:	BA
	DWG. NO.:		
	PC01 OF 1		
	SHEET NO.:		
	2 OF 2		

